

IN-SET

3x1 squary with cover set

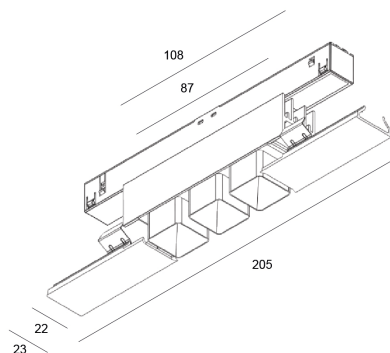

9T.3141



## POLAR LDC

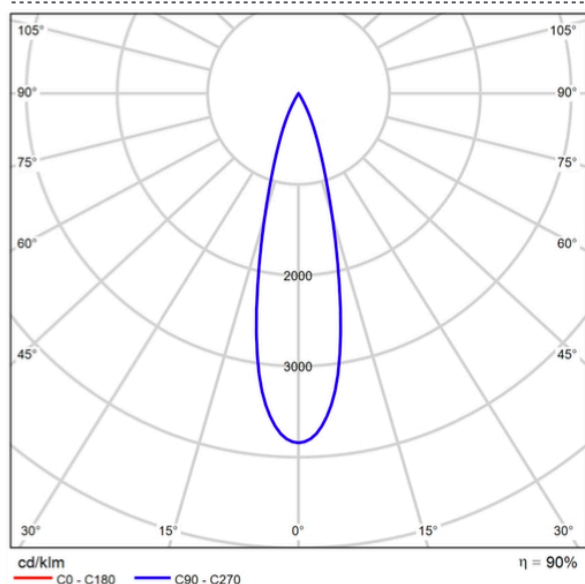

## CONE DIAGRAM

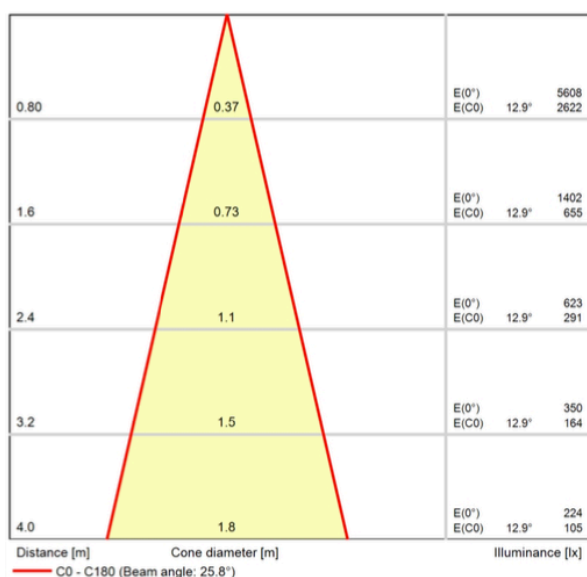

## DESCRIPTION

IN-SET 3x1 recessed square downlight with cover set, containing 3 narrow beam TIR-lenses 15° and led sources

## FIXTURE

**housing finish** BL black anodised

**visor + base finish** BL black anodised  
GO gold anodised  
GM gun metal anodised  
BR bronze anodised

**IP rating** IP40

## ELECTRICAL FEATURES

**power** D DALI (driver included)

**Current** V4 constant voltage 48v

## LIGHT SOURCE

**LED quantity** 3

**Lamp power** 9 W

**Lamp flux** 934 lm

**Luminaire flux** 841 lm

**Efficiency** %90

**Luminous efficacy** 93,3 lm/W

**LED temperature** 4 2400°K  
7 2700°K  
3 3000°K  
5 3500°K

**CRI** 93

**UGR** ≤ 10

## OPTICS

**Beam angle** 1 15°

## PRODUCT CODES FOR ORDER INFORMATION

		model	beam angle	housing finish	visor/base finish	LED temperature	power	current
		<b>314</b> IN-SET 3x1 Squary with cover set	<b>1</b> 15° beam	<b>BL</b> black anodised	<b>BL</b> black anodised <b>GO</b> gold anodised <b>GM</b> gun metal anodised  <b>BR</b> bronze anodised	<b>4</b> 2400°K <b>7</b> 2700°K <b>3</b> 3000°K <b>5</b> 3500°K	<b>D</b> DALI (driver included)	<b>V4</b> constant voltage 48v
<b>9</b>	<b>T</b>	.	.	.	.	.	.	.

## ADDITIONAL DOWNLOADS

[Installation Instructions](#)

[Photometric Files](#)

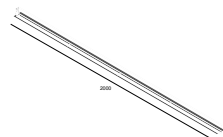
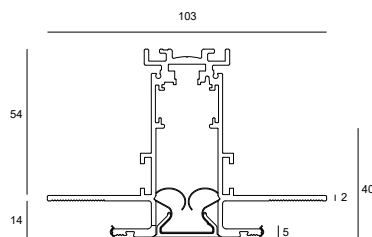
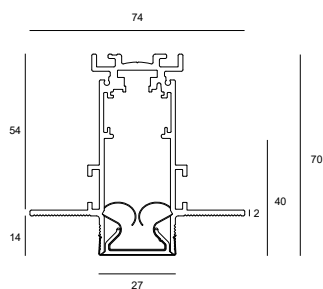
**7T.2020.BL0**

recessed track for dry ceilings 2 meter ( 48V + dali )

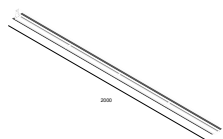
**7T.1020.BL0**

recessed track for gypsum ceilings 2 meter ( 48V + dali )

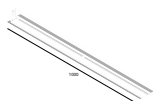
**7T.1010.BL0**

recessed track for gypsum ceilings 1 meter ( 48V + dali )

**7T.0100.BL0**

set of endocarps ( 2p )

**7T.0110.BL0**

electrical feeder

**7T.0120.BL0**

electrical coupler

**7T.0130.BL0**

mechanical coupler (2p)

**7T.0140.BL0**

hanging set for track (2p)

**7T.9900**

cutting tool for shortening conductors