

IN-SET

3x1 round with cover set

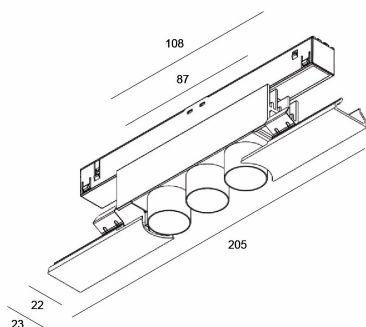

9T.3101



POLAR LDC

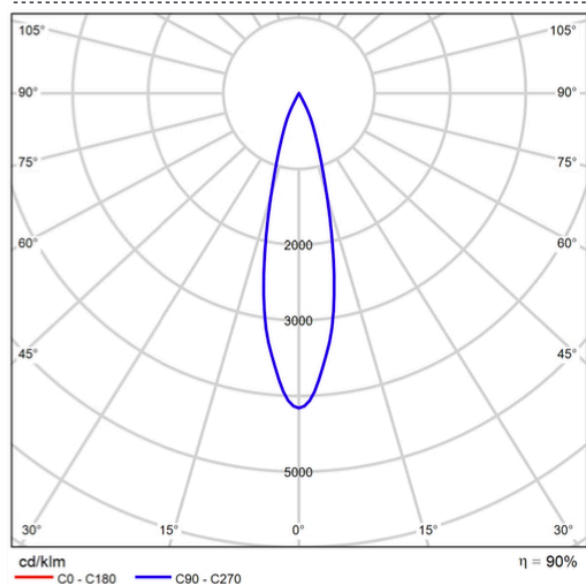

CONE DIAGRAM

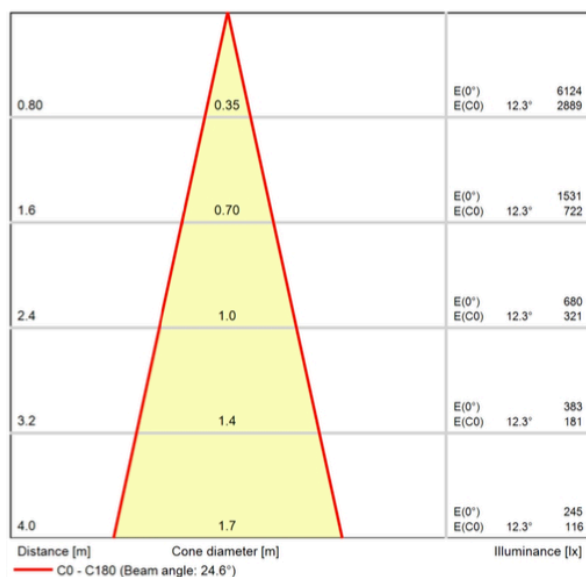

DESCRIPTION

IN-SET 3x1 recessed rounded downlight with cover set, containing 3 narrow beam TIR-lenses 15° and led sources

FIXTURE

housing finish BL black anodised

visor + base finish
BL black anodised
GO gold anodised
GM gun metal anodised
BR bronze anodised

IP rating IP40

ELECTRICAL FEATURES

power D DALI (driver included)

Current V4 constant voltage 48v

LIGHT SOURCE

LED quantity 3

Lamp power 9 W

Lamp flux 942 lm

Luminaire flux 848 lm

Efficiency %90

Luminous efficacy 94,1 lm/W

LED temperature
4 2400°K
7 2700°K
3 3000°K
5 3500°K

CRI 93

UGR ≤ 10

OPTICS

Beam angle 1 15°

PRODUCT CODES FOR ORDER INFORMATION

		model	beam angle	housing finish	visor/base finish	LED temperature	power	current
		310 IN-SET 3x1 Round with cover set	1 15° beam	BL black anodised	BL black anodised GO gold anodised GM gun metal anodised BR bronze anodised	4 2400°K 7 2700°K 3 3000°K 5 3500°K	D DALI (driver included)	V4 constant voltage 48v
9	P

ADDITIONAL DOWNLOADS

Installation Instructions Photometric Files 

ADDITIONAL ACCESSORIES

3x1 round with cover set

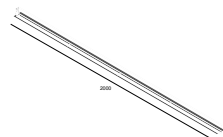
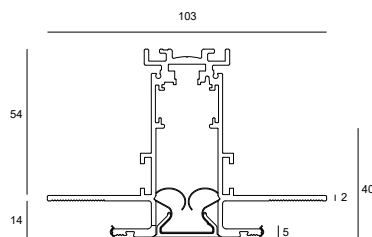
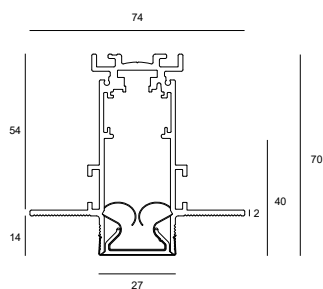
**7T.2020.BL0**

recessed track for dry ceilings 2 meter (48V + dali)

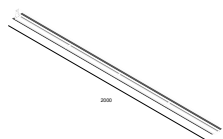
**7T.1020.BL0**

recessed track for gypsum ceilings 2 meter (48V + dali)

**7T.1010.BL0**

recessed track for gypsum ceilings 1 meter (48V + dali)

**7T.0100.BL0**

set of endocarps (2p)

**7T.0110.BL0**

electrical feeder

**7T.0120.BL0**

electrical coupler

**7T.0130.BL0**

mechanical coupler (2p)

**7T.0140.BL0**

hanging set for track (2p)

**7T.9900**

cutting tool for shortening conductors