

IN-SET  
ESS with cover set

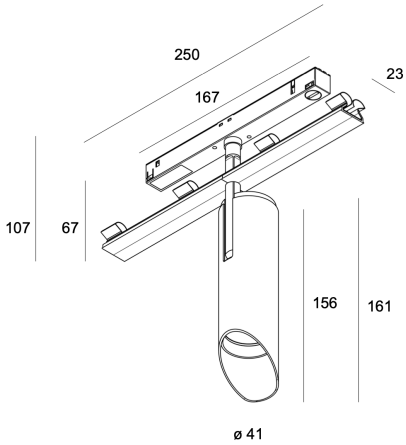

9T.2001



DESCRIPTION

IN-SET ESS spot with cover set, containing 18° beam angle lens.

FIXTURE

housing finish BL black anodised

visor + base finish WH white RAL9010 powder coated  
BL black anodised  
GO gold anodised  
GM gun metal anodised  
SI matte silver anodised  
BR bronze anodised

IP rating IP40

ELECTRICAL FEATURES

power D DALI (driver included)

Current V4 constant voltage 48v

LIGHT SOURCE

LED quantity 1

Lamp power 9,3 W

Lamp flux 706 lm

Luminaire flux 705 lm

Efficiency %99,84

Luminous efficacy 75,8 lm/W

LED temperature 7 2700°K  
3 3000°K

CRI 90

UGR ≤ 10

OPTICS

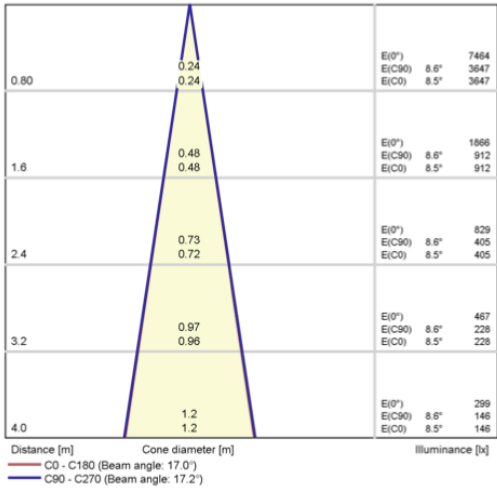
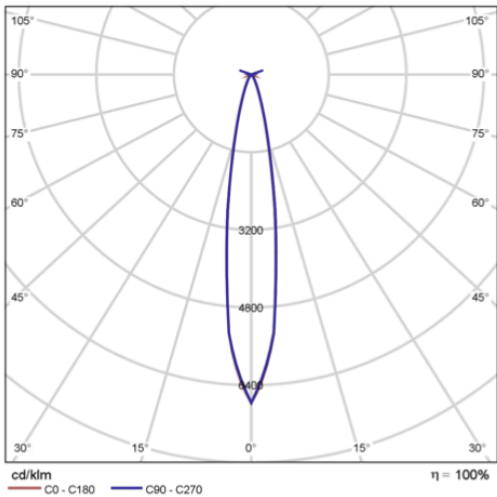

Beam angle 3 18°



PRODUCT CODES FOR ORDER INFORMATION

		model	beam angle	housing finish	visor/base finish	LED temperature	power	current
		<b>200</b> IN-SET ESS with cover set	<b>3</b> 18° beam	powder coated <b>BL</b> black	<b>BL</b> black anodised <b>GO</b> gold anodised <b>GM</b> gun metal anodised <b>BR</b> bronze anodised	<b>7</b> 2700°K <b>3</b> 3000°K	<b>D</b> DALI (driver included)	<b>V4</b> constant voltage 48v
9	T	.	.	.	.	.	.	.

ADDITIONAL DOWNLOADS

- Installation Instructions
- Photometric Files
-   

\*Black54 reserves the right of discontinuing or replacing products inside this database

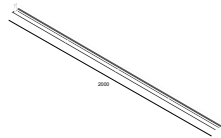
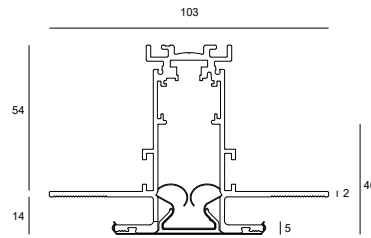
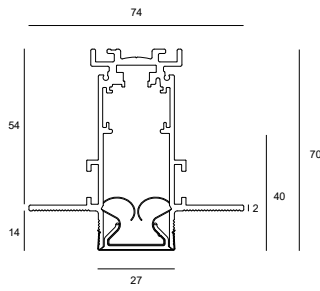
**7T.2020.BL0**

recessed track for dry ceilings 2 meter ( 48V + dali )

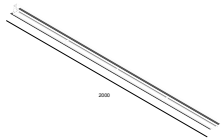
**7T.1020.BL0**

recessed track for gypsum ceilings 2 meter ( 48V + dali )

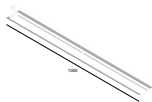
**7T.1010.BL0**

recessed track for gypsum ceilings 1 meter ( 48V + dali )

**7T.0100.BL0**

set of endocarps ( 2p )

**7T.0110.BL0**

electrical feeder

**7T.0120.BL0**

electrical coupler

**7T.0130.BL0**

mechanical coupler (2p)

**7T.0140.BL0**

hanging set for track (2p)

**7T.9900**

cutting tool for shortening conductors