

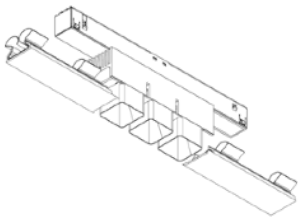

IN-SET

3x1 squary with cover set



9T.3141

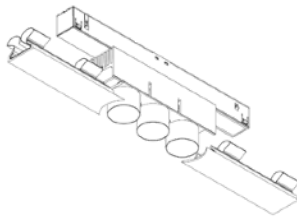

9T.3101

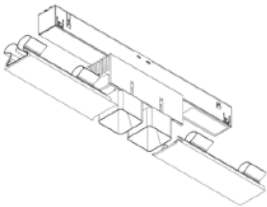

9T.2141

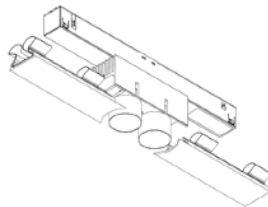

9T.2101

CONE DIAGRAM

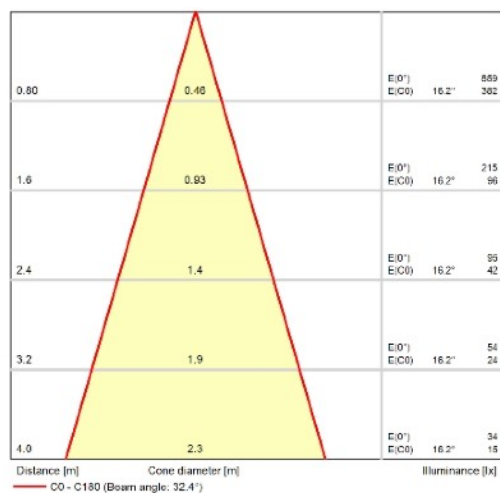

POLAR LDC

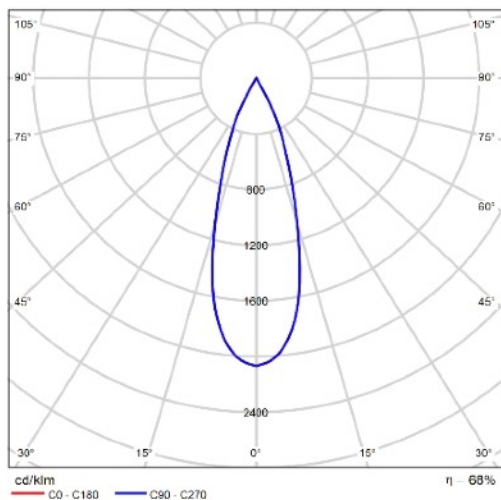

LINEAR LDC

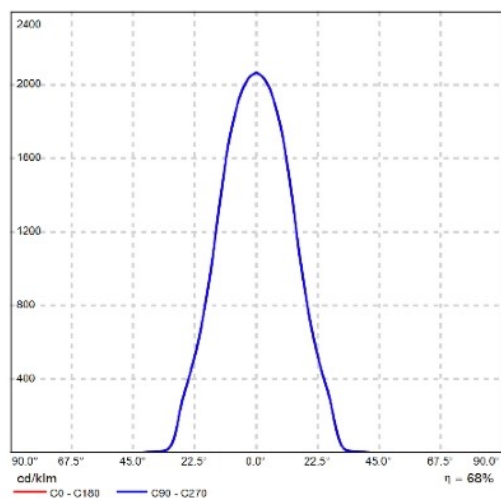

DESCRIPTION

IN-SET 3x1 recessed square downlight with cover set, containing 3 narrow beam TIR-lenses 15° and led sources

FIXTURE

housing finish	BL black anodised
visor + base finish	BL black anodised GO gold anodised GM gun metal anodised BR bronze anodised

IP Rating	IP44
-----------	------

ELECTRICAL FEATURES

9.P.1011	9.P.1021
9.P.1411	9.P.1421

Power	D DALI (driver included)
-------	--------------------------

Current	C7 C7 / V2
---------	---------------

LIGHT SOURCE (data at 2700°K)

LED Quantity	2 3
--------------	--------

Lamp Power (700 mA)	4 W 6 W
---------------------	------------

Lamp Power (1000 mA)	5,7 W 8,7 W
----------------------	----------------

Lamp Flux (700 mA)	390 lm 585 lm
--------------------	------------------

Lamp Flux (1000 mA)	532 lm 798 lm
---------------------	------------------

Luminaire Flux (700 mA)	268 lm 414 lm
-------------------------	------------------

Luminaire Flux (1000 mA)	364 lm 564 lm
--------------------------	------------------

Efficiency	%68
------------	-----

Luminous Efficacy	67,3 lm/W
-------------------	-----------

LED Temperature	7A 2700°K 3A 3000°K 8A 4000°K
-----------------	-------------------------------------

CRI	97
-----	----

R09	53
-----	----

UGR	< 6 2x1, 3x1 rounded <16 2x1, 3x1 squary
-----	---

OPTICS

Beam Angle	1 15 degree beam
------------	------------------

PRODUCT CODES FOR ORDER INFORMATION

		model	beam angle	housing finish	visor/base finish	LED temperature	power	current
		314 IN-SET 3x1 Squary with cover set	1 15° beam	BL black anodised	BL black anodised GO gold anodised GM gun metal anodised BR bronze anodised	4 2400°K 7 2700°K 3 3000°K 5 3500°K	D DALI (driver included)	V4 constant voltage 48v
9	T

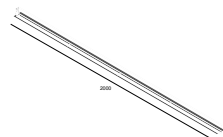
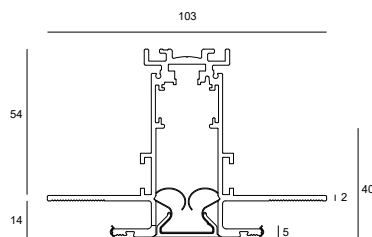
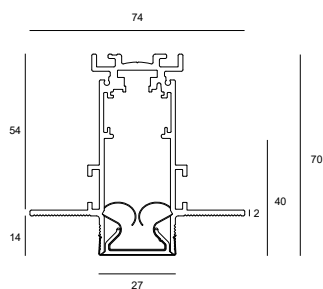
**7T.2020.BL0**

recessed track for dry ceilings 2 meter (48V + dali)

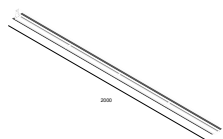
**7T.1020.BL0**

recessed track for gypsum ceilings 2 meter (48V + dali)

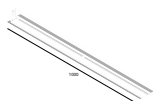
**7T.1010.BL0**

recessed track for gypsum ceilings 1 meter (48V + dali)

**7T.0100.BL0**

set of endocarps (2p)

**7T.0110.BL0**

electrical feeder

**7T.0120.BL0**

electrical coupler

**7T.0130.BL0**

mechanical coupler (2p)

**7T.0140.BL0**

hanging set for track (2p)

**7T.9900**

cutting tool for shortening conductors