

IN-SET
ESSm

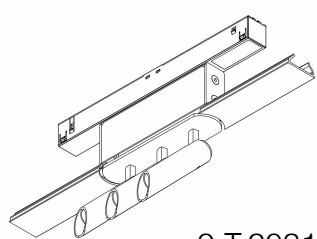

9.T.2031

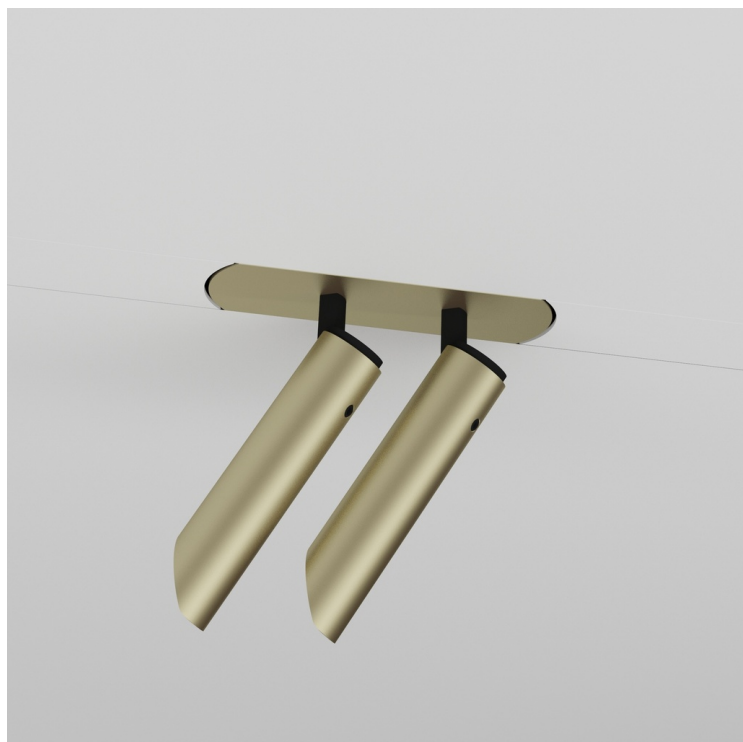
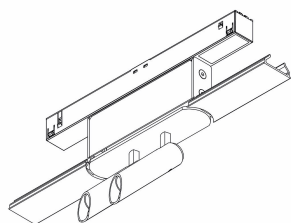

9.T.2021

LUMINANCE DIAGRAM

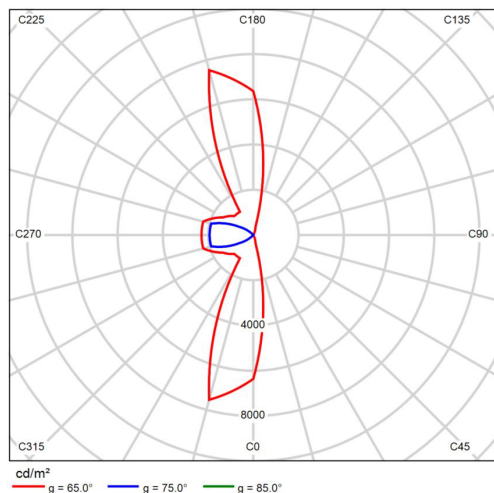

POLAR LDC

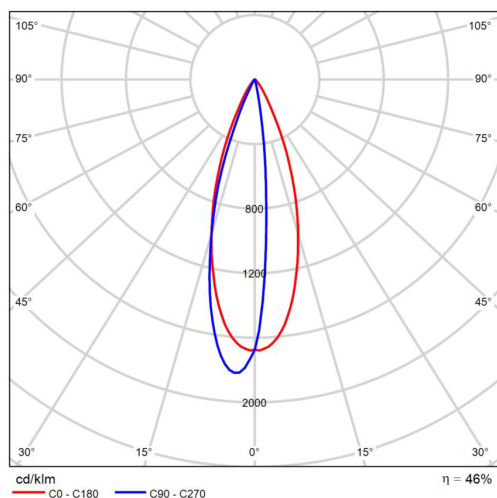

LINEAR LDC

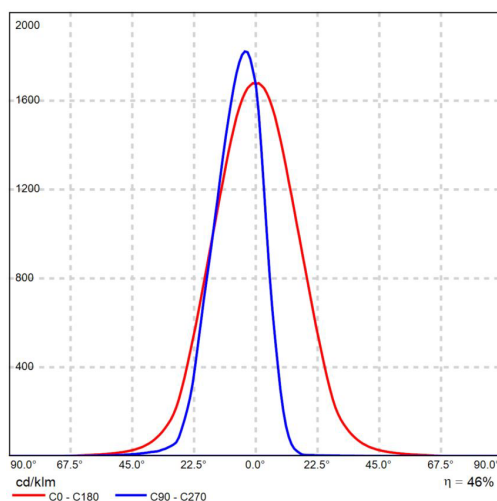

DESCRIPTION

IN-SET with ESSm

FIXTURE

Housing Finish	WH white RAL9010 powder coated
Visor	BL black anodised
Base Finish	GO gold anodised
	GM gun metal anodised
	SI matte silver anodised
	BR bronze anodised

IP Rating IP20

ELECTRICAL FEATURES

Power D dimmable DALI (driver included)

Current V4 constant voltage 48v

LIGHT SOURCE

LED Quantity	1	2
Power	2,18 W	4,36 W
Source Flux	212 lm	424 lm
Luminaire Flux	157,26 lm	314,52 lm
Source Efficacy	97,25 lm/W	97,25 lm/W
Luminaire Efficacy	72,14 lm/W	72,14 lm/W
Optical Efficiency	%74,18	%74,18

LED Temperature 7A 2700°K
3A 3000°K
8A 4000°K

CRI 97

R09 89

UGR < 22

OPTICS

Beam Angle 1 15 degree beam

COLOR FIDELITY BY SAMPLE

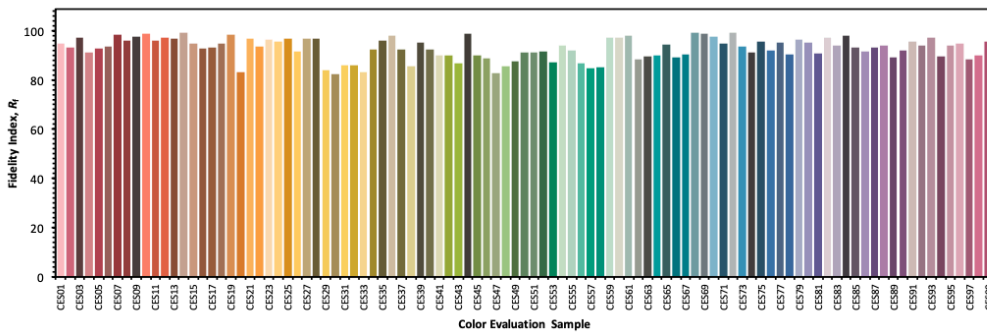

u'	0,2628
v'	0,5254
x	0,4574
y	0,4064
Δuv	*0,0014
R9	89

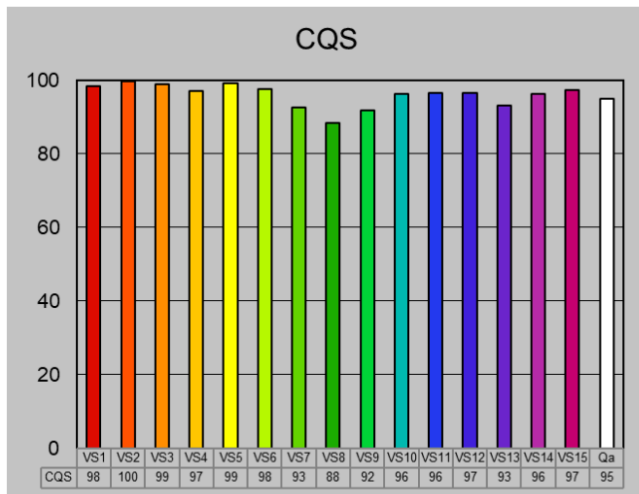

Rg@3000K	105
Rf@3000K	93

COLOR VECTOR GRAPHIC

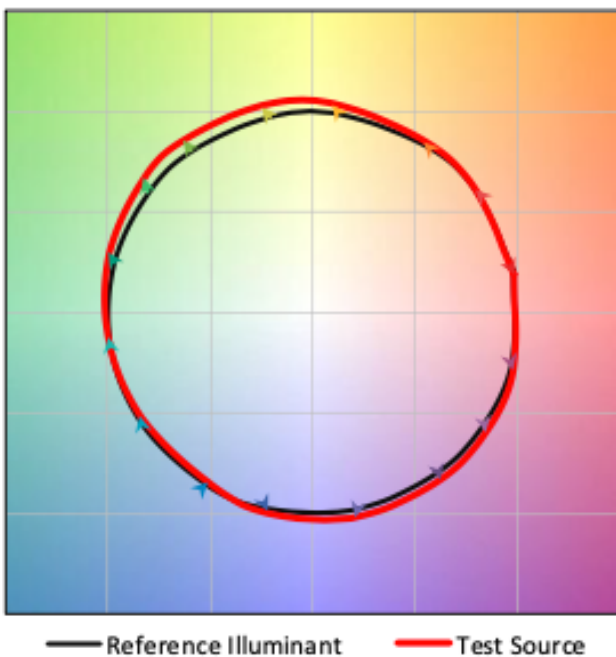

FIDELITY INDEX

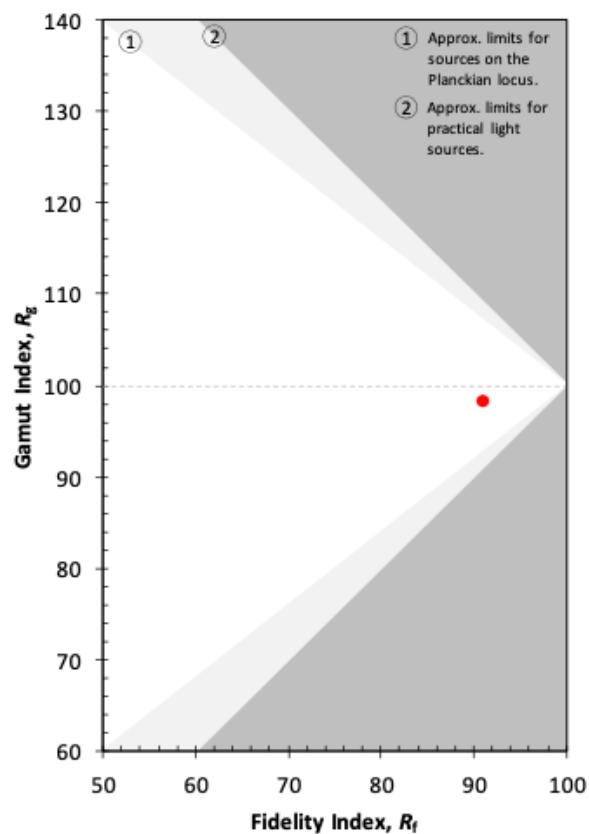

PRODUCT CODES FOR ORDER INFORMATION

model	beam angle	housing finish	visor/base finish	LED temperature	power	current
202 IN-SET 2 ESSm with cover set 203 IN-SET 3 ESSm with cover set	1 15 degree beam	WH white RAL9010 powder coated BL black anodised GO gold anodised GM gun metal anodised SI matte silver anodised BR bronze anodised	BL black anodised	7A 2700°K 3A 3000°K 8A 4000°K	D dimmable DALI (driver included)	V4 constant voltage 48v
9 . P

*Black54 reserves the right of discontinuing or replacing products inside this database

IN-SET ACCESSORIES

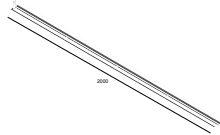
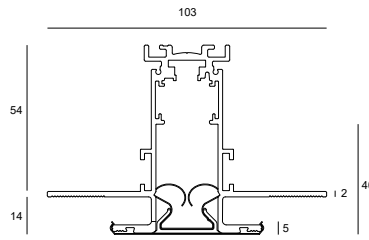
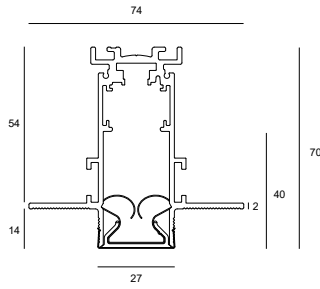

7.T.2020.BL0

recessed track for dry ceilings 2 meter (48V + dali)

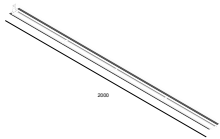

7.T.1020.BL0

recessed track for gypsum ceilings 2 meter (48V + dali)

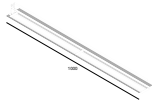

7.T.1010.BL0

recessed track for gypsum ceilings 1 meter (48V + dali)



7.T.0100.BL0

set of end caps (2p)



7.T.0110.BL0

electrical feeder



7.T.0120.BL0

electrical coupler



7.T.0130.BL0

mechanical coupler (2p)



7.T.0140.BL0

hanging set for track (2p)



7.T.9900

cutting tool for shortening conductors