

OFF-SET

OFF-SET NT asymmetric trimless

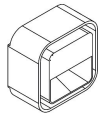

9.N.1015



9.N.1415

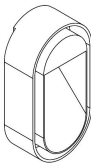

9.N.1035

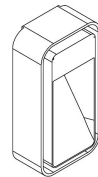

9.N.1435



9.N.1025

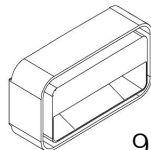

9.N.1425

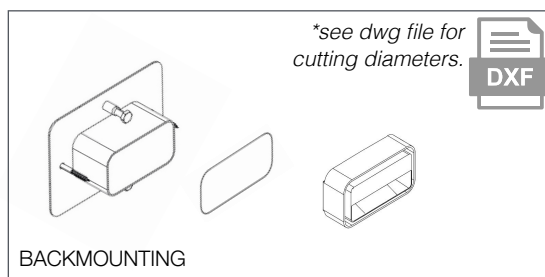
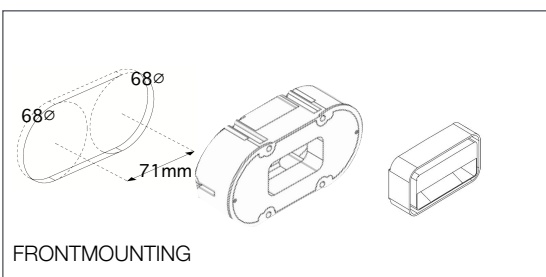
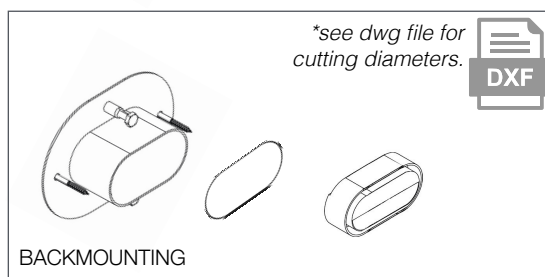
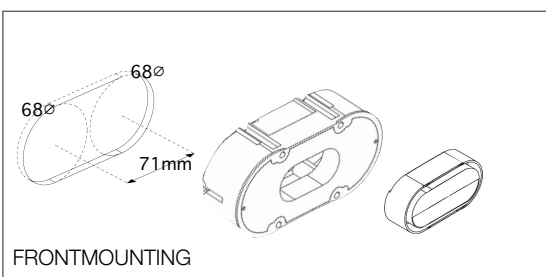
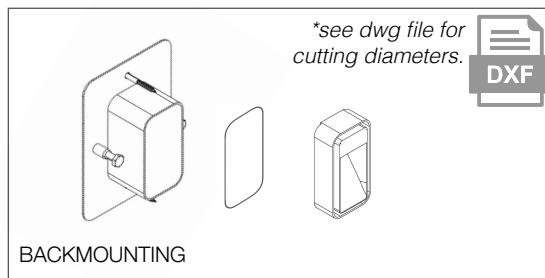
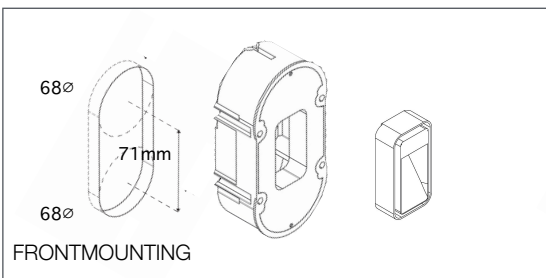
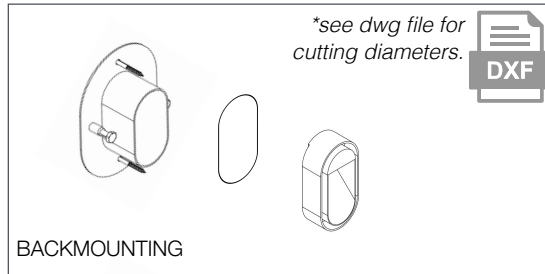
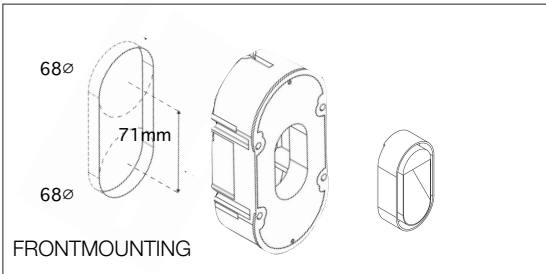
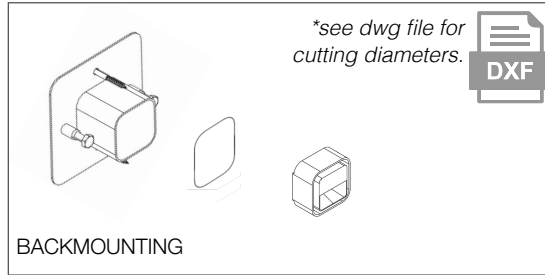
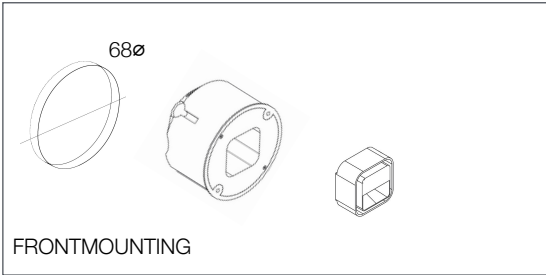
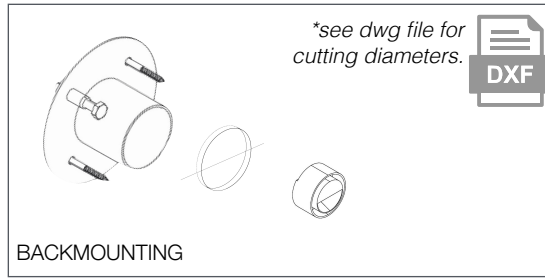
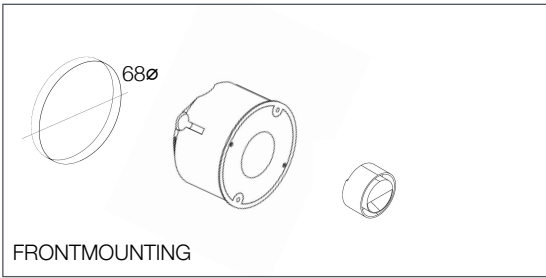

LUMINANCE DIAGRAM

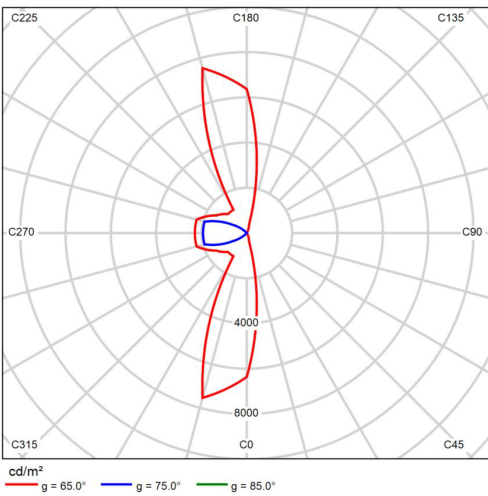

POLAR LDC

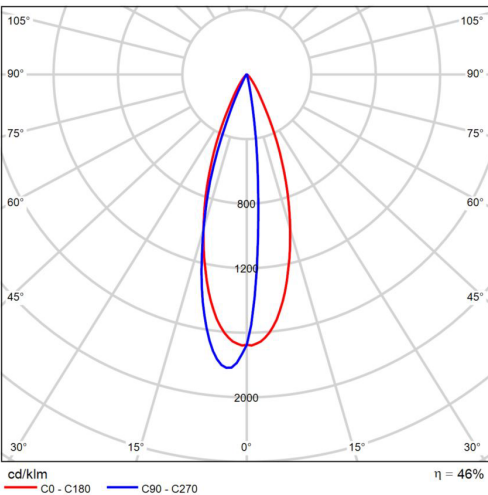

LINEAR LDC

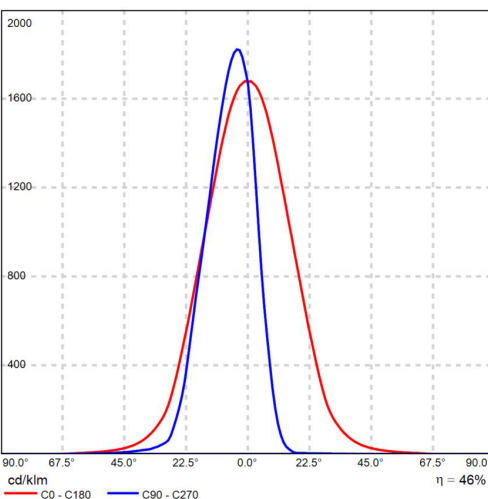

DESCRIPTION

OFF-SET NT trimless units with 1x1, 2x1, asymmetrical beam

FIXTURE

Housing Finish
 WH white RAL9010 powder coated
 BL black anodised
 GO gold anodised
 GM gun metal anodised
 SI matte silver anodised
 BR bronze anodised

Visor/Base finish
 BL black anodised
 GO gold anodised
 GM gun metal anodised
 BR bronze anodised

IP Rating IP20

ELECTRICAL FEATURES

9.N.1015
 9.N.1025
 9.N.1415
 9.N.1425
 9.N.1035
 9.N.1435

Power E dimmable (driver excluded)

Current **C7** constant current 700mA **C7** constant current 700mA
V2 constant voltage 24v

LIGHT SOURCE (data at 2700°K)

LED Quantity	1	2
Power (700 mA)	2,09 W	4,17 W
Power (1000 mA)	3,16 W	6,31 W
Source Flux (700 mA)	182,50 lm	365 lm
Source Flux (1000 mA)	248,50 lm	497 lm
Luminaire Flux (700 mA)	79,92 lm	159,83 lm
Luminaire Flux (1000 mA)	106,73 lm	213,46 lm
Source Efficacy (700 mA)	87,62 lm/W	87,62 lm/W
Source Efficacy (1000 mA)	78,80 lm/W	78,80 lm/W
Luminaire Efficacy (700 mA)	38,37 lm/W	38,37 lm/W
Luminaire Efficacy (1000 mA)	33,85 lm/W	33,85 lm/W
Optical Efficiency (700 mA)	%43,79	%43,79
Optical Efficiency (1000 mA)	%42,95	%42,95
LED Temperature	4 2400°K 7 2700°K <i>*(other Kelvin degrees upon request)</i>	
CRI	90	
R09	53	
UGR	Not symmetric	

OPTICS

Beam Angle 5 asymmetric beam

COLOR FIDELITY BY SAMPLE

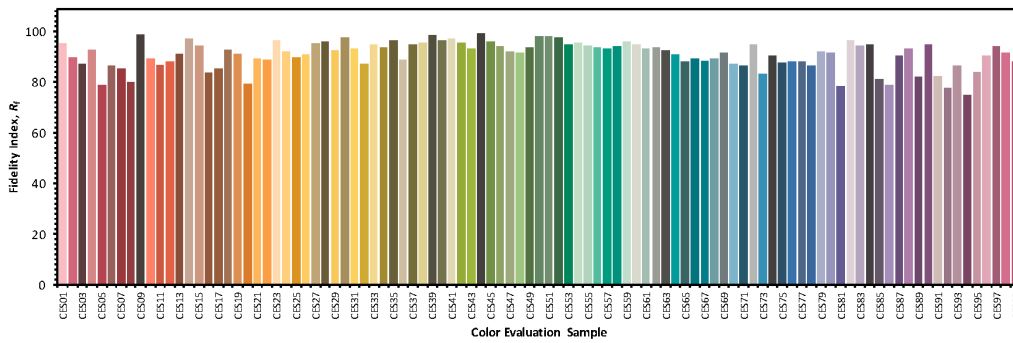

u'	0,2604
v'	0,5270
x	0,4569
y	0,4110
Δuv	0,0004
R9	53

CQS

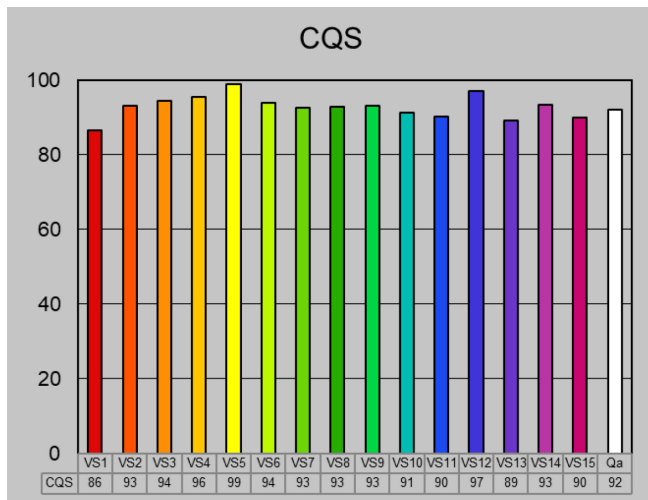

Rg@2700K	99
Rf@2700K	91

COLOR VECTOR GRAPHIC

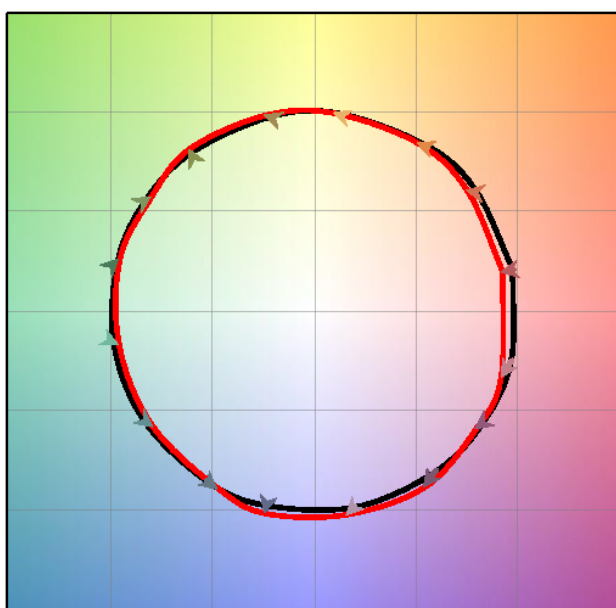

— Reference Source — Test Source

FIDELITY INDEX

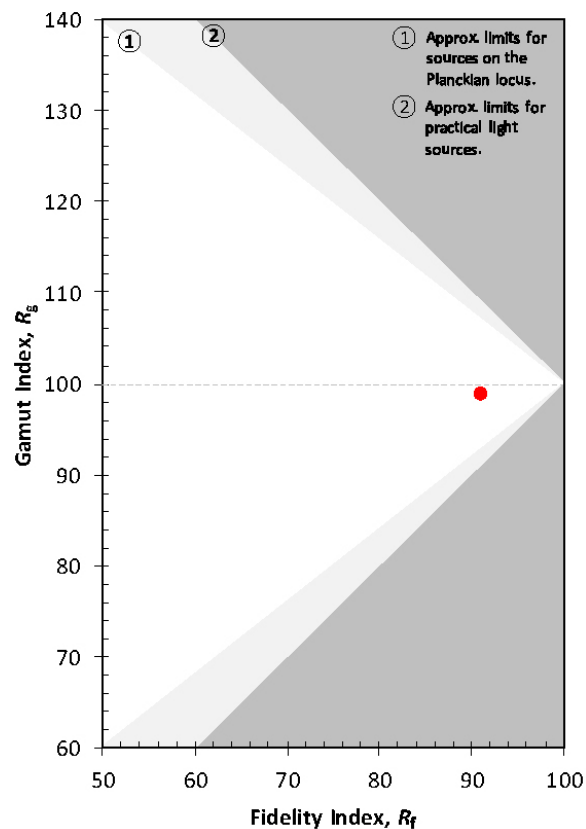

- ① Approx. limits for sources on the Planckian locus.
- ② Approx. limits for practical light sources.

PRODUCT CODES FOR ORDER INFORMATION

OFF-SET NT asymmetric trimless

model	beam angle	housing finish	visor/base finish	LED temperature	power	current
101 rounded 1x1 asymmetric trimless 141 square 1x1 asymmetric trimless 103 vertical 1x1 asymmetric trimless 143 horizontal square 1x1 asymmetric trimless	5 asymmetric beam	-	BL black anodised GO gold anodised GM gun metal anodised BR bronze anodised	4 2400°K 7 2700°K <i>*(other Kelvin degrees upon request)</i>	E dimmable (driver excluded)	C7 constant current 700mA
9 . N

model	beam angle	housing finish	visor/base finish	LED temperature	power	current
102 horizontal rounded 2x1 asymmetric trimless 142 horizontal square 2x1 asymmetric trimless	5 asymmetric beam	-	BL black anodised GO gold anodised GM gun metal anodised BR bronze anodised	4 2400°K 7 2700°K <i>*(other Kelvin degrees upon request)</i>	E dimmable (driver excluded)	C7 constant current 700mA V2 constant voltage 24v
9 . N

*Black54 reserves the right of discontinuing or replacing products inside this database

OFF-SET NT ACCESSORIES

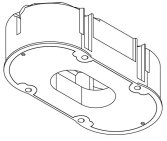
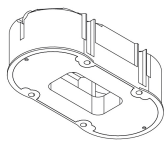
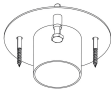
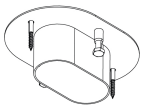
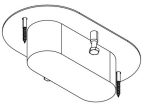
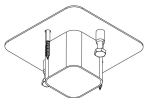
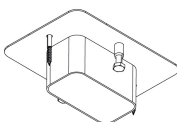
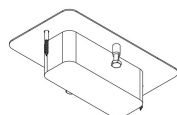
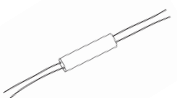
**7.P.101** 1x1 front mounting tool rounded**7.P.102** 2x1 front mounting tool rounded**7.P.141** 1x1 front mounting tool square**7.P.142** 2x1 front mounting tool square**7.P.201** 1x1 back mounting tool rounded**7.P.202** 2x1 back mounting tool rounded**7.P.203** 3x1 back mounting tool rounded**7.P.241** 1x1 back mounting tool square**7.P.242** 2x1 back mounting tool square**7.P.243** 3x1 back mounting tool square**7.P.7000** DCDC converter 700mA/24V dc