

OFF-SET
OFF-SET NT stone

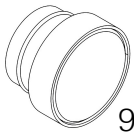

9.S.3017

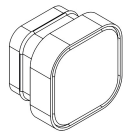

9.S.3417

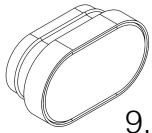

9.S.3027



9.S.3427

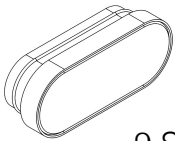

9.S.3037

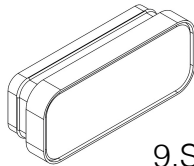

9.S.3437

CUTTING DIAMETERS AND MOUNTING

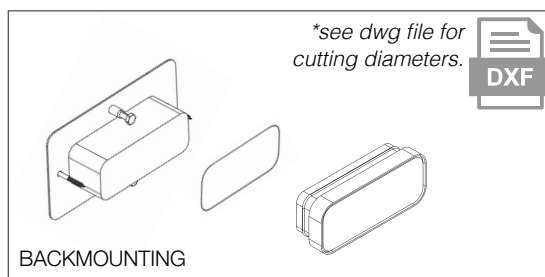
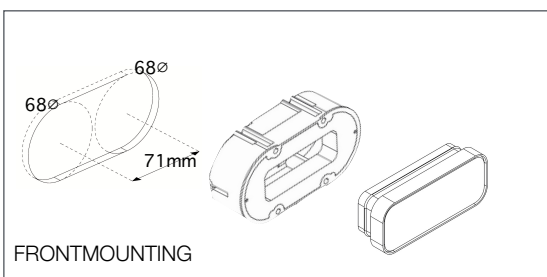
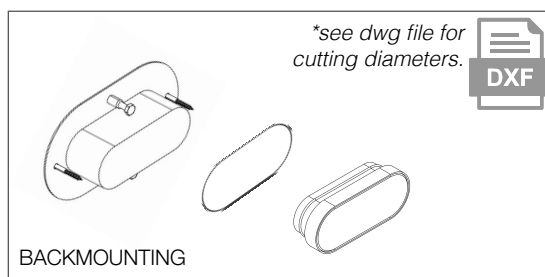
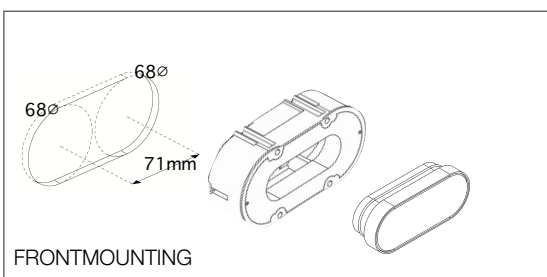
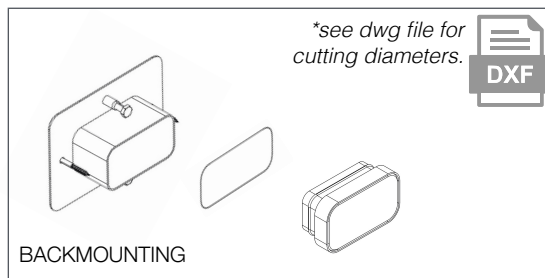
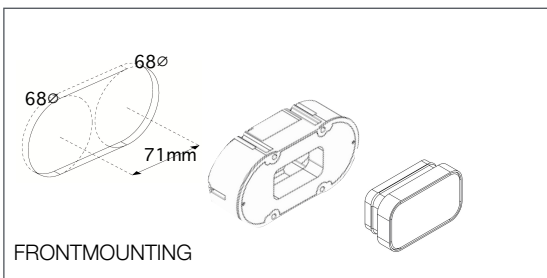
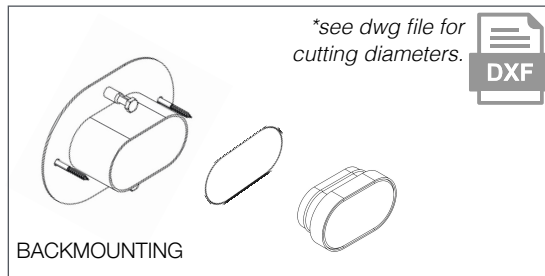
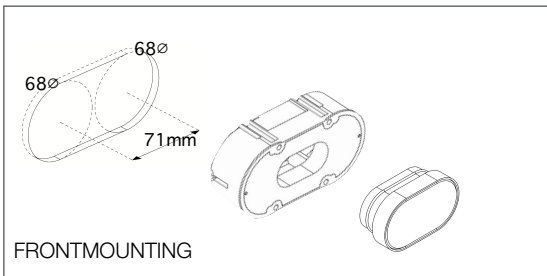
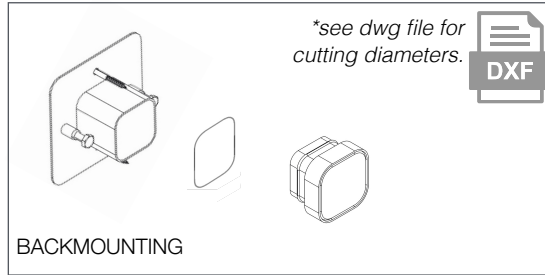
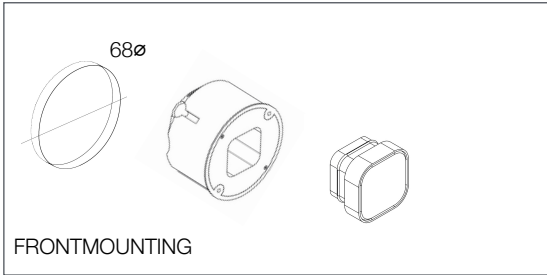
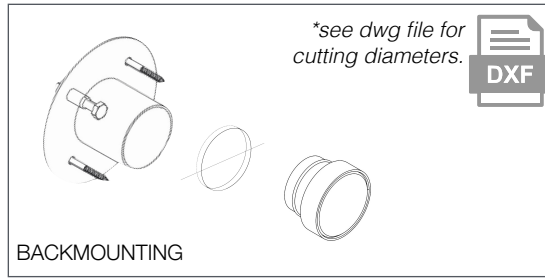
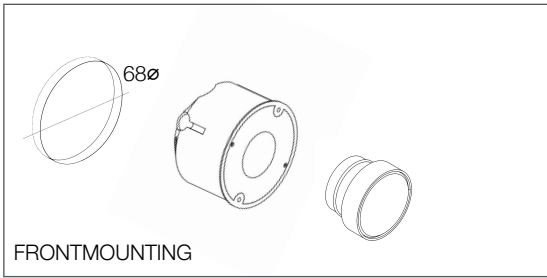

*Black54 reserves the right of discontinuing or replacing products inside this database

LUMINANCE DIAGRAM

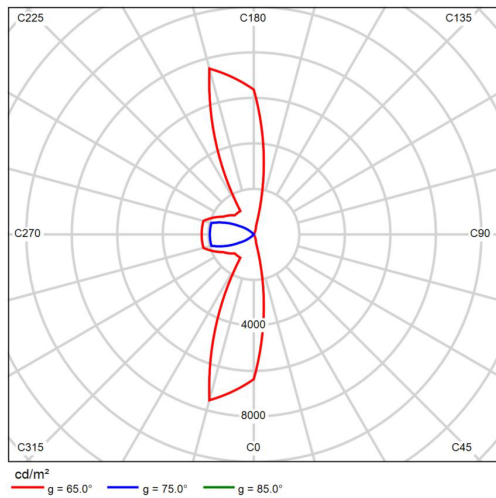

POLAR LDC

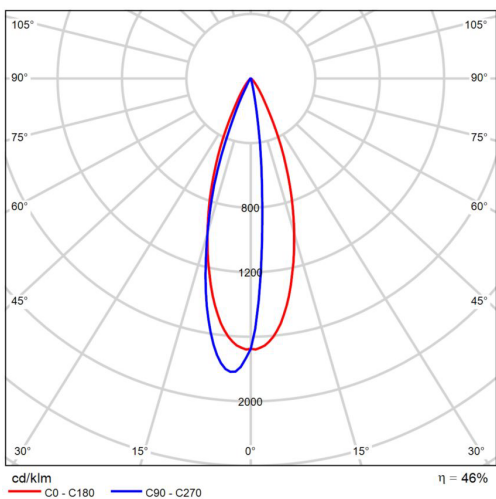

LINEAR LDC

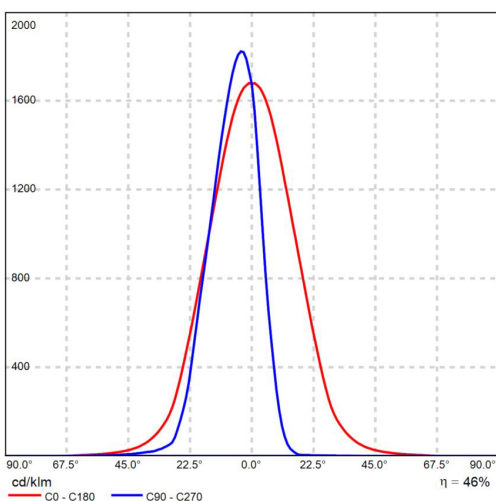

DESCRIPTION

OFF-SET NT stone with diffused light

FIXTURE

Visor + Base Finish
 WH white RAL9010 powder coated
 BL black anodised
 GO gold anodised
 GM gun metal anodised
 SI matte silver anodised
 BR bronze anodised

IP Rating IP44

ELECTRICAL FEATURES

	9.S.3017	9.S.3027	9.S.3037
	9.S.3417	9.S.3427	9.S.3437
Power	E dimmable (driver excluded)		
Current	C7	C7 / V2	C7 / V2
LIGHT SOURCE (data at 2700°K)			
LED Quantity	1	2	3
Power (700 mA)	2,34 W	4,68 W	7,02 W
Power (1000 mA)	3,69 W	7,38 W	11,07 W
Source Flux (700 mA)	158 lm	316 lm	474 lm
Source Flux (1000 mA)	225 lm	450 lm	675 lm
Luminaire Flux (700 mA)	17,47 lm	34,94 lm	52,41 lm
Luminaire Flux (1000 mA)	22,97 lm	45,94 lm	68,91 lm
Source Efficacy (700 mA)	67,38 lm/W	67,38 lm/W	67,38 lm/W
Source Efficacy (1000 mA)	61,04 lm/W	61,04 lm/W	61,04 lm/W
Luminaire Efficacy (700 mA)	7,45 lm/W	7,45 lm/W	7,45 lm/W
Luminaire Efficacy (1000 mA)	6,23 lm/W	6,23 lm/W	6,23 lm/W
Optical Efficiency (700 mA)	%11,06	%11,06	%11,06
Optical Efficiency (1000 mA)	%10,21	%10,21	%10,21
LED Temperature	4 2400°K 7 2700°K <i>*(other Kelvin degrees upon request)</i>		
CRI	89,5		
R09	46		
UGR	< 24		
OPTICS			
Beam Angle	7 diffuse light		

*Black54 reserves the right of discontinuing or replacing products inside this database

COLOR FIDELITY BY SAMPLE

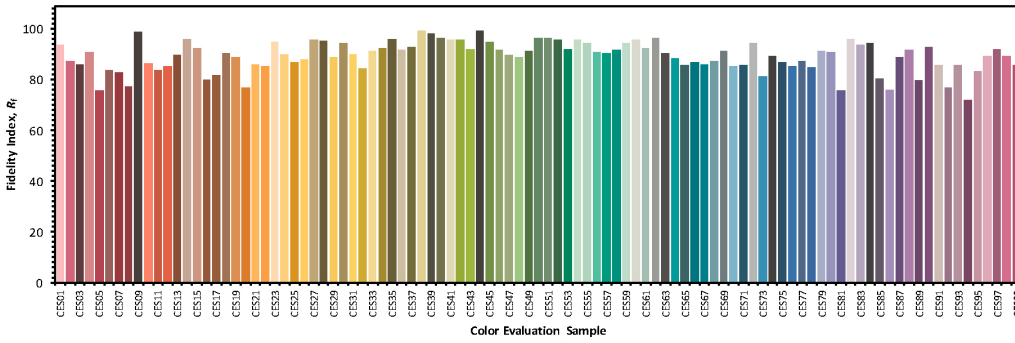

u'	0,2744
v'	0,5336
x	0,4835
y	0,4179
Δuv	0,0012
R9	46

CQS

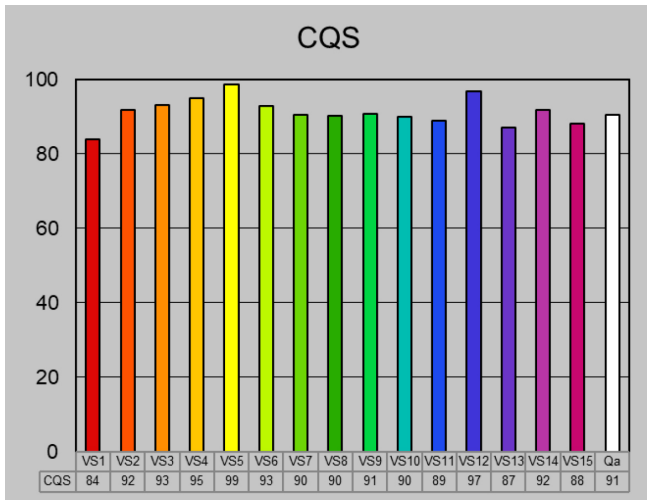

Rg@2700K	99
Rf@2700K	89

COLOR VECTOR GRAPHIC

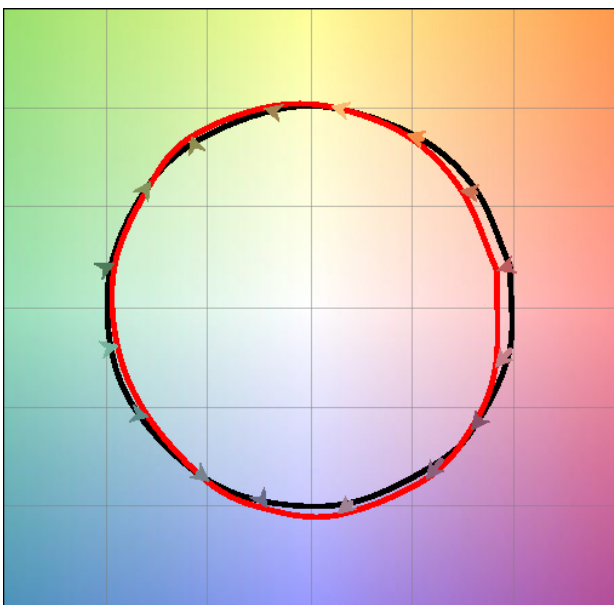

— Reference Source — Test Source

FIDELITY INDEX

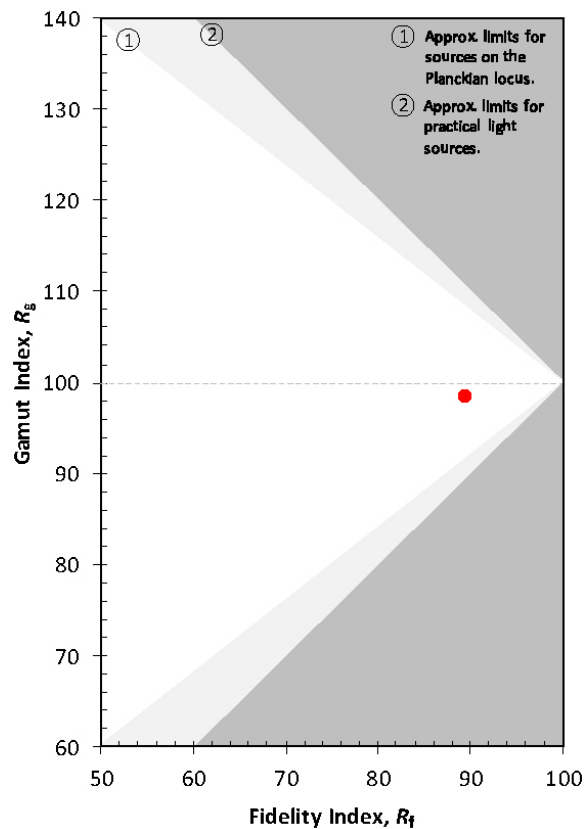

PRODUCT CODES FOR ORDER INFORMATION

			model	beam angle	housing finish	visor/base finish	LED temperature	power	current
			301 NT 1x1 round with diffused light 341 NT 1x1 square on rectangular recess	7 diffuse light	WH white RAL9010 powder coated BL black anodised GO gold anodised GM gun metal anodised SI matte silver anodised BR bronze anodised	-	4 2400°K 7 2700°K	E dimmable (driver excluded)	C7 constant current 700mA
9	.	N

			model	beam angle	housing finish	visor/base finish	LED temperature	power	current
			302 NT 2x1 long rounded with diffused light 303 NT 3x1 long rounded with diffused light 342 NT 2x1 long rectangular with diffused light 343 NT 3x1 long rectangular with diffused light	7 diffuse light	WH white RAL9010 powder coated BL black anodised GO gold anodised GM gun metal anodised SI matte silver anodised BR bronze anodised	-	4 2400°K 7 2700°K	E dimmable (driver excluded)	C7 constant current 700mA V2 constant voltage 24v
9	.	N

*Black54 reserves the right of discontinuing or replacing products inside this database

ACCESSORIES



7.P.101 1x1 front mounting tool rounded

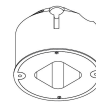

7.P.141 1x1 front mounting tool squary

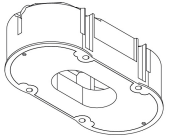

7.P.102 2x1 front mounting tool rounded

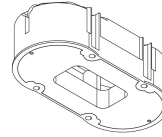

7.P.142 2x1 front mounting tool squary

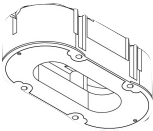

7.P.103 3x1 front mounting tool rounded

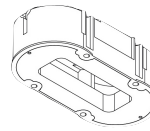

7.P.143 3x1 front mounting tool squary

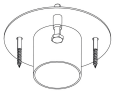

7.P.201 1x1 back mounting tool rounded

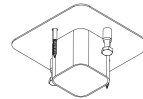

7.P.241 1x1 back mounting tool squary

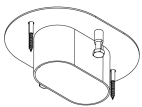

7.P.202 2x1 back mounting tool rounded

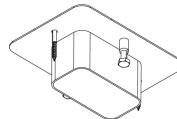

7.P.242 2x1 back mounting tool squary

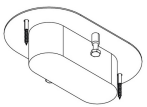

7.P.203 3x1 back mounting tool rounded

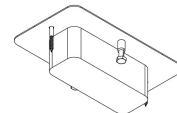

7.P.243 3x1 back mounting tool squary

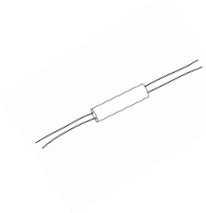

7.P.7000 DCDC converter 700mA/24V dc

*Black54 reserves the right of discontinuing or replacing products inside this database